

## Xpedition



Celebrity Cruises' newest ship is one that sails you back into history, through the fabled waters surrounding the Galapagos Islands. Cruise aboard Celebrity Xpedition and you'll experience a sense of intimacy that can only be achieved aboard a smaller ship. And yet, Celebrity Xpedition is filled with touches that are luxuriously familiar. Morning mimosas, daily massages and moonlit toasts are just a few of the spoils you'll enjoy as you embrace the timelessness of the Galapagos Islands - a land that time has seemingly forgotten.

### SHIP FACTS

**Tonnage:** 2329

**Date commissioned:** 2001

**Country of registration:** Ecuador

**Regular capacity:** 94

**Language spoken:** Multi-Language

**Length:** 296 feet

### FACILITIES/ON-BOARD ACTIVITIES

#### *Entertainment/Recreation*

Discovery Lounge

Blue Finch Bar

Beach Club

Hot Tub

Sauna

#### *Health and Beauty*

Spa

Beauty Centre

#### *Shopping*

Gift Shop

#### *Dining*

Beagle Grill

Darwin's Restaurant

24-hour Room Service

### STATEROOM AMENITIES

**All staterooms or suites offer**

20" television

Shower

Hair dryer

100% Egyptian-cotton towels

Complimentary use of bathrobes

Closet

Direct dial telephone

**Ocean View Stateroom aprox. 145 square feet. Category XO**

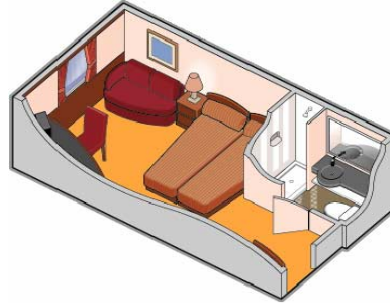

**Features:** Convertible double or single beds, sea-view portholes and sitting area.

**Deluxe Ocean-view Stateroom aprox. 160 square feet. Category XD**



**Features:** Convertible double or single beds, sea-view portholes and sitting area.

**Premium Ocean-view Stateroom aprox. 160 square feet. Category XP**

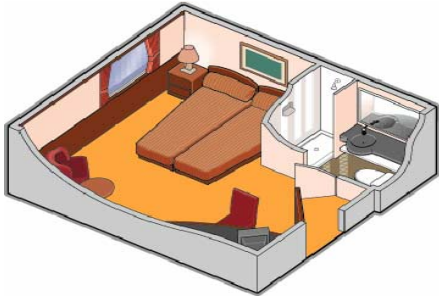

**Features:** Convertible double or single beds, sea-view windows and sitting area with sofa.

**Xpedition Suite with Veranda aprox. 230 square feet. Category XS**

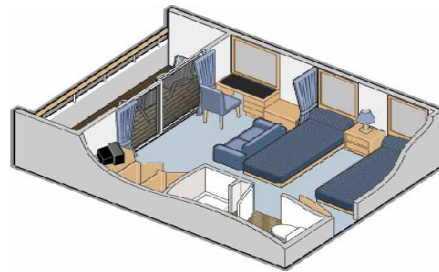

**Features:** Convertible double or single beds, floor-to-ceiling sliding glass doors that lead to your personal veranda, and sitting area with sofa

**Penthouse Suite with 2 Verandas aprox. 460 square feet. Category PS**



**Features:** Two single beds and one double bed, floor-to-ceiling sliding glass doors that lead to two personal verandas, and sitting area with sofa.

## **DINING INFORMATION**

Breakfast	Buffet
Lunch	Buffet
Dinner	7:30 pm General Seating

On the Celebrity Expedition you have several dining options, including the main dining room at Darwin's Restaurant, selections served on deck throughout the day at the Beagle Grill, or complimentary rooms service.

### **Darwin's Restaurant**

Located on the Marina Deck, Darwin's Restaurant is where you'll discover culinary wonders that are sure to dazzle the palate as well as please the eye. Crisp white linen, fine crystal and exemplary service make dining amongst the islands as special and memorable as the islands themselves.

### **Beagle Grill**

Named after the ship that first brought young Mr. Darwin to these rugged shores, the Beagle Grill is where you can enjoy casual fare in an equally casual, relaxed setting. The Beagle Grill offers a delightful view that ensures your meal will not only be delectable, but memorable as well.

### **Discovery Lounge**

The perfect place to meet and mingle with your fellow guests, the Discovery Lounge is where you can pose questions and offer opinions. Who knows? You might even come up with a theory or two of your own.

### **Blue Finch Bar**

A great place to relax and soak-in the majesty of the Galapagos Islands is the Blue Finch Bar. Order a favorite cocktail and watch the equatorial sun sink into the vast blue of the Pacific.

### **Special Dietary Requirements**

Celebrity can accommodate the following special diets on board: vegetarian, diabetic, low-fat, low-sodium and low-cholesterol. Dietary requests need to be made in writing no later than 60 days prior to sailing.

## **Clothing**

While sailing aboard the Xpedition guests will require two types of clothing. Casual Explorers Day Wear and Casual Evening Wear.

**Casual Explorers Day Wear** – lightweight, comfortable clothing suited for walking/hiking. This includes;

- Lightweight or cotton pants and shorts
- Lightweight short-sleeved and long-sleeved shirts such as polo shirts and cotton t-shirts, lightweight rain jacket/wind breaker, and sweatshirts
- Comfortable walking shoes or lightweight hiking boots, and waterproof sandals for wet landings
- Two or more bathing suites, as well as extra sunblock, sun hats, sunglasses and other types of sun protection.

**Casual Evening Wear**

For ladies this includes;

- Casual dress or skirt
- Blouse or pants outfit
- Sweaters, jackets/windbreakers should be packed.

For men this includes;

- Slacks or pants
- Dress shirt
- Polo or collared shirt
- Sweaters, jackets/windbreakers should be packed.

**Gratuity Policies** – Included in the fare are gratuities to shipboard staff, lecturers, as well as gratuities for the naturalist guides. Also included are beverages including house wine, champagne, liquor, beer and soda.