

Mercury



For those who may wonder if there's life on Mercury, we're here to tell you that there most definitely is. Part of the Century-class of ships, Mercury is equally as impressive, and not just in terms of visual appeal, but also in the vast array of world-class amenities and services that she offers.

SHIP FACTS

Tonnage: 77,700

Date commissioned: 1997

Country of registration: Bahamas

Regular capacity: 1870

Maximum capacity: 1882

Number of crew: 909

Crew nationality: Multinational

Officer nationality: Greek

Language spoken: Multi-Language

Length: 866 feet

FACILITIES/ON-BOARD ACTIVITIES

Athletic/Exercise Facilities

9 Hole Golf Putting Course
Aerobic and Exercise Room
Golf Simulators
Gymnasium
Jogging Track
Sports Court
Sports Equipment
Weight Training Equipment

Entertainment/Recreation

Bars/Lounges/ Night Clubs - 4
Card Rooms
Disco
Fine Art Exhibition and Art Auction

Library
Movie Theater/Cinema
Nautica/Spa
Photo Shop and Photo Gallery
Pools - Indoor - 2
Pools - Outdoor - 3
Shuffleboard Courts
Sports Deck
Table Tennis
Video Arcade
Volleyball
Whirlpools – 4

Health and Beauty

Health Spa (with whirlpools)
Hair Salon

Dining

Cafe - 3
Dining Rooms - 2
Grill
Room Service

Shopping

Boutique - 4
Gift Shop

Services

Medical Centre
Cabins for Disabled
Handicapped Accommodations

Children

Kids Pool Area
Teen Center

Ship Facilities

Air Conditioning
Diesel Electronic Propulsion System
Electric Current(220AC/110AC)
Elevators - 3
Guest Decks - 5
Observation Lounge
Passenger Decks - 10
Wheelchair-accessible Cabins – 8

STATEROOM AMENITIES

All rooms offer

2 twin beds that can convert to a queen
Color TV
Private bar
Hair Dryer

Closet
Shower
Safe
Direct dial Telephone with voicemail

Interior aprox. 171 square feet. Categories 9, 10, 11, 12



Ocean-view aprox. 172 square feet. Categories 4, 5, 6, 7, 8

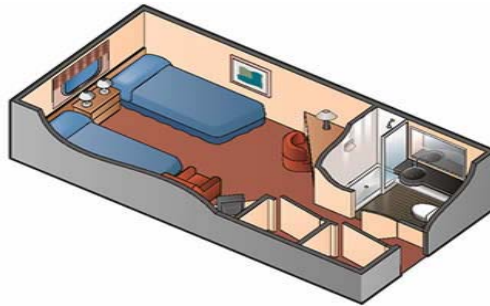

Family Ocean-view Stateroom aprox 210 square feet. Category FO

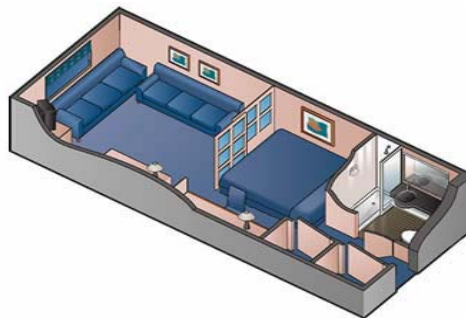

Includes additional features
Panoramic window
Double bed
Sitting area with sofa bed

Premium Ocean-view with Veranda aprox. 172 square feet including Veranda. Category 2A.

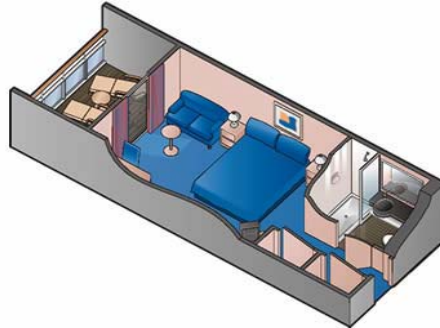

Includes additional features

Floor-to-ceiling glass-paneled door
Sofa bed with sitting area
Veranda

Concierge Class with Veranda aprox. 172 square feet including Veranda. Category CC.

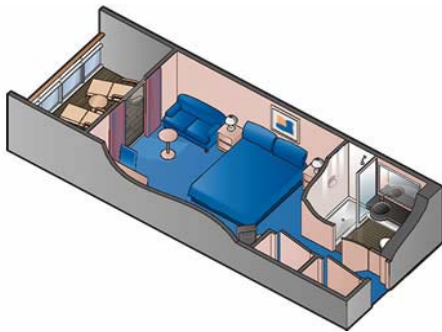

Includes additional features

Floor-to-ceiling glass-paneled door
Sofa bed with sitting area
Veranda

When you stay in a Celebrity Concierge Class Stateroom you will receive these added amenities and more:

- Welcome champagne
- Daily fruit selection
- Fresh-cut flowers
- Daily hors d'oeuvres
- Menu of pillows - Conformance, Body, Goose, and Isotonic®
- Duvets and pillow-top mattresses
- Leather key holder, personalized stationery, a tote bag and umbrella
- Double-thick Frette bathrobes
- Hansgrohe® showerhead
- VIP invitations to events
- Early embarkation and debarkation

- Dining and seating preference
- Preference on shore excursions
- Express luggage delivery

Sky Suite approx. 246 square feet including Veranda. Category SS



Includes additional features

Floor-to-ceiling windows/sliding-glass door
 Sitting area with sofa bed
 Veranda
 Private bathroom with tub.

Sky Suite Indulgences

When you stay in Sky Suite on Century you will receive these added amenities:

- 24-hour European butler service
- Priority check-in and departing
- Priority luggage delivery at boarding
- Welcome champagne
- Dining room seating preference
- Personalized stationery
- Celebrity tote bag
- 100% cotton oversized bath towels
- Complimentary use of bathrobes
- Private portrait sitting
- Opportunity to book in-suite massage
- Complimentary use of Thalassotherapy pool

Royal Suite aprox. 537 square feet including Veranda. Category RS



Includes additional features

Floor-to-ceiling windows/sliding-glass door
Bedroom with two lower beds convertible to queen-size
Separate living room with dining area
Entertainment center with VCR and CD player
Walk-in closet and dressing room
Private bathroom with a whirlpool tub, a separate shower
Sofa bed
Veranda.

Royal Suite Indulgences

When you stay in Royal Suite on Century you will receive these added amenities:

- 24-hour European butler service
- Priority check-in and departing
- Priority luggage delivery at boarding
- Welcome champagne
- Dining room seating preference
- Personalized stationery
- Celebrity tote bag
- 100% cotton oversized bath towels
- Complimentary use of bathrobes
- Private portrait sitting
- Opportunity to book in-suite massage
- Complimentary use of Thalassotherapy pool

Penthouse Suite aprox. 1101 square feet including Veranda. Category PS.



Includes additional features

Floor-to-ceiling windows

Bedroom with king-size bed

Separate living room

Dining room with butler's pantry/wet bar

Two entertainment centers with DVD player, VCR and CD player, fax machine

Walk-in closet/dressing room

Oversize private bathroom with tub/shower, double sinks

Guest powder room

Queen-size sofa bed

Veranda with whirlpool.

Penthouse Suite Indulgences

When you stay in Penthouse Suite on Century you will receive these added amenities:

- 24-hour European butler service
- Priority check-in and departing
- Priority luggage delivery at boarding
- Welcome champagne
- Dining room seating preference
- Personalized stationery
- Celebrity tote bag
- 100% cotton oversized bath towels
- Complimentary use of bathrobes
- Private portrait sitting
- Opportunity to book in-suite massage
- Complimentary use of Thalassotherapy pool

DINING INFORMATION

Dinner

Number of Dinner Sittings: 2

Usual Dinner Hours: Breakfast 7:30 AM & 8:45 AM, Luncheon 12:00 PM & 1:30 PM, Dinner 6:15 PM & 8:30 PM

Main Dining

As you enter Celebrity's main dining room, crystal glasses, exquisite china and gleaming silverware shine in anticipation. A dramatic setting for any meal, this elegant dining room

features an endless array of cuisine including breakfast, lunch and dinner - all prepared under the guidance of award-winning Master Chef Michel Roux.

Perfectly presented and incredibly delicious, Celebrity cuisine is not only abundant, it is prepared following the highest culinary standards.

Casual Dining

On a Celebrity ship, casual dining is just as special and enjoyable as formal dining. While casual dining may include a relaxing poolside grill, the Sushi café or complimentary 24-hour room service, the experience, flavor and attention to detail remain unmatched

Casual Dining Restaurant

Enjoy the same world-class cuisine Celebrity is known for in a more relaxed environment. You'll find yourself going back for more - but remember to save room for dessert. You'll find delectable treats you won't want to miss.

Outdoor Grill

Let your cravings go wild. Order up a pizza of your choice. Grab a burger and fries or pasta dish in a relaxed, poolside environment serving lunch and dinner

Sushi Café

At night, dive into your favorite fresh sushi choices at the Sushi Café. From California Rolls to Nigiri, enjoy the delicious flavor and colorful form of this Japanese culinary art

Cova® Café di Milano

Relax while enjoying a cappuccino and a European pastry with a friend at the Cova Café. Featuring Cova liqueurs, chocolates, and fresh pastries, this jewel offers a scrumptious taste of decadence

AquaSpa Café *Available on Millennium-class ships only

Nestled near the Thalassotherapy Pool, the AquaSpa Café serves a light and healthy cuisine from breakfast until evening. Tranquility permeates the atmosphere lending to a fulfilling casual dining experience.

Special Dietary Requirements

Celebrity satisfies a variety of dietary needs. Menu selections include "Lean and Light", meeting standards recommended by the American Diabetes Association and the American Cancer Society for reduced fat content, children's menus and Pacific Northwest specialties. We are happy to accommodate your special dietary requirements such as vegetarian, kosher, diabetic, low-fat, low-sodium, low-cholesterol, gluten-free and lactose-free diets.

Formal Nights

Celebrity Cruises' elegant, formal evenings include the Captain's Welcome Cocktail Party and Dinner, the Captain's Farewell Dinner, and a third or fourth "formal" night for those cruises sailing more than seven nights. Eveningwear should be planned for according to the length of your cruise. The following schedule outlines the number of formal nights you'll enjoy:

Cruise length	Casual	Informal	Formal
4-night	2	1	1

6-night	2	1	1
7-night	3	2	2
9-night	4	2	3
10-night	5	2	3
11-night	5	3	3
12-night	6	3	3
14-night	7	4	3

Before Six

Dining options abound aboard Celebrity. For breakfast and lunch, jeans, shorts and casual daywear are allowed in all dining venues before 6:00pm. After 6:00pm, this attire is allowed only in casual restaurants and cafés

Evening Dress Codes

Celebrity's evening dress codes include three types: formal, casual and informal. The daily program, delivered to your stateroom and available at the Guest Relations Desk, will be your guide to the appropriate evening attire

Formal Night Attire

Ladies: Evening gown or fancy dress
Gentlemen: Tuxedo, dinner jacket or dark suit

Informal Night Attire

Ladies: Informal dress or pants and blouse
Gentlemen: Jacket and tie with slacks

Casual Night Attire

Ladies: Pantsuit or sporty outfit
Gentlemen: Sport shirt and slacks

Gratuities Policies

Waiter: \$3.50 p/day

Busboy: \$2.00 p/day

Butler (suites only): \$3.50 p/day

Steward/ess: \$3.50 p/day

Chief Housekeeper: .50 p/day