

Celebrity Century



Soaring atriums, dazzling combinations of wood, glass and marble and state-of-the-art amenities are just a few of the delights you'll find aboard Century. Recognized among the top ships in the world, Century's expansive floor-to-ceiling windows and sweeping staircases provide a visually intoxicating backdrop for unforgettable vacation memories.

SHIP FACTS

Tonnage: 70,606

Date commissioned: 1995

Country of registration: Liberia

Regular capacity: 1750

Maximum capacity: 1770

Number of crew: 858

Crew nationality: Multinational

Officer nationality: Greek

Language spoken: Multi-Language

Length: 815 feet

FACILITIES/ON-BOARD ACTIVITIES

Athletic/Exercise Facilities

Aerobic and Exercise Room

Basketball Court

Golf Simulators

Gymnasium

Jogging Track

Sports Equipment

Weight Training Equipment

Entertainment/Recreation

Bars/Lounges/ Night Clubs – 4

Card Rooms

Jacuzzi

Movie Theater/Cinema

Pools - Outdoor - 2

Shuffleboard Courts

Skeet Shooting
Sports Deck
Table Tennis
Video Arcade
Volleyball
Whirlpools - 4

Health and Beauty

Health Spa (with whirlpools)
Massage Room
Medical Center
Sauna/Steam Rooms

Dining

Café
Grill – 2
Room Service

Services

Beauty Salon
Cabins for Disabled
Handicapped Accommodations
Laundry/Ironing/Dry Cleaning Service

Ship Facilities

Air Conditioning
Electric Current (220AC/110AC)
Elevators - 9
Guest Decks - 10
Laundry Facilities
Wheelchair-accessible Cabins – 8

STATEROOM AMENITIES

All rooms offer

2 twin beds that can convert to a queen
Color TV
Private bar
Hair Dryer
Closet
Shower
Safe
Direct dial Telephone with voicemail

Interior aprox. 175 square feet. Categories 9, 10, 11, 12

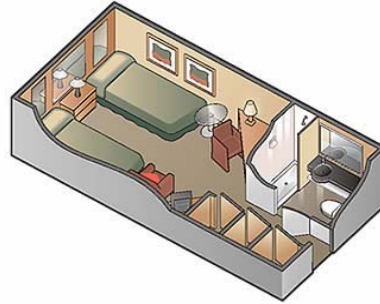

Ocean-view approx. 175 square feet. Categories 3, 4, 5, 6, 7, 8



Celebrity Concierge Class approx. 175 square feet. Category CC

Includes additional features

Larger closet

Desk

Celebrity Concierge Class Stateroom on Century is similar to an outside cabin but with the these added amenities and more:

- Welcome champagne
- Daily fruit selection
- Fresh-cut flowers
- Daily hors d'oeuvres
- Menu of pillows - Conformance, Body, Goose, and Isotonic®
- Duvets and pillow-top mattresses
- Leather key holder, personalized stationery, a tote bag and umbrella
- Double-thick Frette bathrobes
- Hansgrohe® showerhead
- VIP invitations to events
- Early embarkation and debarkation
- Dining and seating preference
- Preference on shore excursions
- Express luggage delivery

Century Suite aprox. 190 square feet including Veranda. Category CS



Includes additional features

Floor-to-ceiling glass-paneled door

Private veranda

Sofa bed with sitting area

Century Suite Indulgences

When you stay in Century Suite on Century you will receive these added amenities:

- 24-hour European butler service
- Priority check-in and departing
- Priority luggage delivery at boarding
- Welcome champagne
- Dining room seating preference
- Personalized stationery
- Celebrity tote bag
- 100% cotton oversized bath towels
- Complimentary use of bathrobes
- Private portrait sitting
- Opportunity to book in-suite massage
- Complimentary use of Thalassotherapy pool

Sky Suite aprox. 244 square feet including Veranda. Category SS

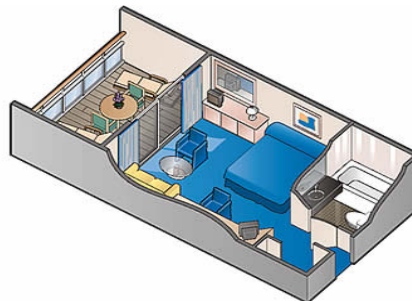

Includes additional features

Floor-to-ceiling windows/sliding-glass door
Sitting area with sofa bed
Veranda
Private bathroom with tub.

Sky Suite Indulgences

When you stay in Sky Suite on Century you will receive these added amenities:

- 24-hour European butler service
- Priority check-in and departing
- Priority luggage delivery at boarding
- Welcome champagne
- Dining room seating preference
- Personalized stationery
- Celebrity tote bag
- 100% cotton oversized bath towels
- Complimentary use of bathrobes
- Private portrait sitting
- Opportunity to book in-suite massage
- Complimentary use of Thalassotherapy pool

Royal Suite aprox. 506 square feet including Veranda. Category RS**Includes additional features**

Floor-to-ceiling windows/sliding-glass door
Bedroom with two lower beds convertible to queen-size
Separate living room with dining area
Entertainment center with VCR and CD player
Walk-in closet and dressing room
Private bathroom with a whirlpool tub, a separate shower
Sofa bed
Veranda.

Royal Suite Indulgences

When you stay in Royal Suite on Century you will receive these added amenities:

- 24-hour European butler service
- Priority check-in and departing
- Priority luggage delivery at boarding
- Welcome champagne
- Dining room seating preference
- Personalized stationery
- Celebrity tote bag
- 100% cotton oversized bath towels
- Complimentary use of bathrobes
- Private portrait sitting
- Opportunity to book in-suite massage
- Complimentary use of Thalassotherapy pool

Penthouse Suite aprox. 1101 square feet including Veranda. Category PS.



Includes additional features

- Floor-to-ceiling windows
- Bedroom with king-size bed
- Separate living room
- Dining room with butler's pantry/wet bar
- Two entertainment centers with DVD player, VCR and CD player, fax machine
- Walk-in closet/dressing room
- Oversize private bathroom with tub/shower, double sinks
- Guest powder room
- Queen-size sofa bed
- Veranda with whirlpool.

Penthouse Suite Indulgences

When you stay in Penthouse Suite on Century you will receive these added amenities:

- 24-hour European butler service
- Priority check-in and departing
- Priority luggage delivery at boarding
- Welcome champagne
- Dining room seating preference
- Personalized stationery
- Celebrity tote bag
- 100% cotton oversized bath towels
- Complimentary use of bathrobes
- Private portrait sitting

- Opportunity to book in-suite massage
- Complimentary use of Thalassotherapy pool

DINING INFORMATION

Dinner

Number of Dinner Sitzings: 2

Usual Dinner Hours: Breakfast 7:30 AM & 8:45 AM, Luncheon 12:00 PM & 1:30 PM, Dinner 6:15 PM & 8:30 PM

Main Dining

As you enter Celebrity's main dining room, crystal glasses, exquisite china and gleaming silverware shine in anticipation. A dramatic setting for any meal, this elegant dining room features an endless array of cuisine including breakfast, lunch and dinner - all prepared under the guidance of award-winning Master Chef Michel Roux.

Perfectly presented and incredibly delicious, Celebrity cuisine is not only abundant, it is prepared following the highest culinary standards.

Casual Dining

On a Celebrity ship, casual dining is just as special and enjoyable as formal dining. While casual dining may include a relaxing poolside grill, the Sushi café or complimentary 24-hour room service, the experience, flavor and attention to detail remain unmatched

Casual Dining Restaurant

Enjoy the same world-class cuisine Celebrity is known for in a more relaxed environment. You'll find yourself going back for more - but remember to save room for dessert. You'll find delectable treats you won't want to miss.

Outdoor Grill

Let your cravings go wild. Order up a pizza of your choice. Grab a burger and fries or pasta dish in a relaxed, poolside environment serving lunch and dinner

Sushi Café

At night, dive into your favorite fresh sushi choices at the Sushi Café. From California Rolls to Nigiri, enjoy the delicious flavor and colorful form of this Japanese culinary art

Cova® Café di Milano

Relax while enjoying a cappuccino and a European pastry with a friend at the Cova Café. Featuring Cova liqueurs, chocolates, and fresh pastries, this jewel offers a scrumptious taste of decadence

AquaSpa Café *Available on Millennium-class ships only

Nestled near the Thalassotherapy Pool, the AquaSpa Café serves a light and healthy cuisine from breakfast until evening. Tranquility permeates the atmosphere lending to a fulfilling casual dining experience.

Special Dietary Requirements

Celebrity satisfies a variety of dietary needs. Menu selections include "Lean and Light", meeting standards recommended by the American Diabetes Association and the American Cancer Society for reduced fat content, children's menus and Pacific Northwest specialties. We are happy to

accommodate your special dietary requirements such as vegetarian, kosher, diabetic, low-fat, low-sodium, low-cholesterol, gluten-free and lactose-free diets.

Formal Nights

Celebrity Cruises' elegant, formal evenings include the Captain's Welcome Cocktail Party and Dinner, the Captain's Farewell Dinner, and a third or fourth "formal" night for those cruises sailing more than seven nights. Eveningwear should be planned for according to the length of your cruise. The following schedule outlines the number of formal nights you'll enjoy:

Cruise length	Casual	Informal	Formal
4-night	2	1	1
6-night	2	1	1
7-night	3	2	2
9-night	4	2	3
10-night	5	2	3
11-night	5	3	3
12-night	6	3	3
14-night	7	4	3

Before Six

Dining options abound aboard Celebrity. For breakfast and lunch, jeans, shorts and casual daywear are allowed in all dining venues before 6:00pm. After 6:00pm, this attire is allowed only in casual restaurants and cafés

Evening Dress Codes

Celebrity's evening dress codes include three types: formal, casual and informal. The daily program, delivered to your stateroom and available at the Guest Relations Desk, will be your guide to the appropriate evening attire

Formal Night Attire

Ladies: Evening gown or fancy dress
Gentlemen: Tuxedo, dinner jacket or dark suit

Informal Night Attire

Ladies: Informal dress or pants and blouse
Gentlemen: Jacket and tie with slacks

Casual Night Attire

Ladies: Pantsuit or sporty outfit
Gentlemen: Sport shirt and slacks

Gratuity Policies

Waiter: \$3.50 p/day

Busboy: \$2.00 p/day

Butler (suites only): \$3.50 p/day

Steward/ess: \$3.50 p/day

Chief Housekeeper: .50 p/day